

Power Charger Manual Charging Wand Manual

Features / Parts Overview

Product Specifications

Product	Power Charger (PB-01S)	Power Charger (PB-02)
Model Number	PB-01S	PB-02
Battery Type	Lithium-ion Battery	N/A
Battery Capacity	14.4V ≙ 3300mAh (47.52Wh)	N/A
Input	24V ≙ 1.5A(MAX)	
Output	16.4V(MAX) ≙ 3.4A(MAX)	24V ≙ 1.5A(MAX)
Complete Charge Time for Power Charger	< 2 hours	N/A
Complete Charge Time for Shade	< 3 hours	
Charging Temperature	5° C - 35° C / 41° F - 95° F	
Charging Altitude	<1000M	
Dimensions (mm)	58 x 28 x 900 mm	
Approx. Weight (g)	514 g	289 g

Product	36W Power Adapter
Input	100-240 Vac
Output	24V / 1.5A
Dimension (mm)	72.7 x 35.7 x 53mm
Approx. Weight	141 g



reddot winner 2020



CAN ICES-003(B)/NMB-003(B)



Power Charger:(PB-01S) Wireless (with battery) Charging Wand

Dust Cover
To protect the charging connector.
Remove it before charging the shade.

Power Meter for Power Charger (PB-01S)

Green light blinks: charging in progress
Green light: charging complete
Red light: low power

※ Please refer to Power Meter for Power Charger (PB-01S) under section "Definitions of Light Indicators".

Charging Connector
Insert into charging port of the shade to charge the built-in battery.

Power Meter for Shade Battery

Green light blinks: charging in progress
Green light: charging complete
Red light: low power/poor contact

※ Please refer to Power Meter for Shade Battery under section "Definitions of Light Indicators".

Protective Sleeve

To protect the bottom of the Power Charger. No need to remove the protective sleeve when charging.

36W Power Adapter

Power Charger (PB-01S) Wireless (with battery) Charging Wand.

Power Charger:(PB-02) Wired (without battery) Charging Wand

Dust Cover
To protect the charging connector.
Remove it before charging the shade.

Charging Connector
Insert into charging port of the shade to charge the built-in battery.

Power Meter for Shade Battery

Green light blinks: charging in progress
Green light: charging complete
Red light: low power/poor contact

※ Please refer to Power Meter for Shade Battery under section "Definitions of Light Indicators".

Protective Sleeve

To protect the bottom of the Power Charger. No need to remove the protective sleeve when charging.

36W Power Adapter

Extension Cable, length of 2M

Power Charger (PB-02) Wired (without battery) Charging Wand.

Charging the Power Charger (PB-01S) Wireless (with battery) Charging Wand

▲ IMPORTANT:

- Only use the 36W Power Adapter included with this product.
- Please recharge the Power Charger (PB-01S) every 3-6 months to ensure optimal performance of batteries.
- Please charge the power charger(PB-01S) before use.
- For Power Charger(PB-01S), please do not use it to charge the shade while it is being charged/plugged into the outlet.

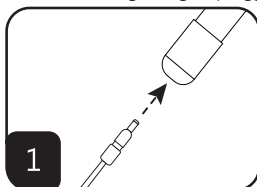

Plug the DC connector of adapter into the Power Charger(PB-01S).

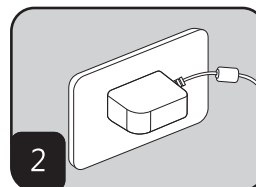

Plug the 36W Power Adapter securely into wall outlet.

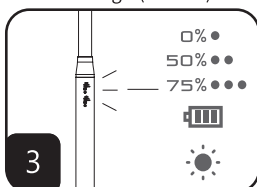

Make sure the green light illuminates/flashes on the Power Charger(PB-01S).

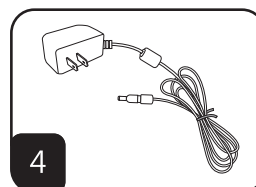

After charging, please store the power adapter well.

Definitions of light Indicators

light Indicator	Battery Capacity	light Display
Power Meter for Shade Battery 0% ● 50% ●● 75% ●●● 	Less than 50%	Green light flashes once every 2 seconds.
	50-75%	Green light flashes twice every 2 seconds.
	75%-90%	Green light flashes three times every 2 seconds.
	Over 90%	Green light illuminates steadily without flashing
	Fault / Poor Connection	Red light. Please refer to "Troubleshooting" for further information.
Power Meter for Power Charger (PB-01S) 0% ● 50% ●● 75% ●●● 	Less than 50%	Green light flashes once every 2 seconds.
	50-75%	Green light flashes twice every 2 seconds.
	75%-90%	Green light flashes three times every 2 seconds.
	Over 90%	Green light illuminates steadily without flashing.
	Fault / Poor Connection	Red Light. Please refer to "Troubleshooting" for further information.

Troubleshooting



While charging the Shade

Light Status	Potential Cause	Solution
<p>The light doesn't illuminate.</p> <p>□% ● 50% ●● 75% ●●●</p> <p>○</p>	<p>The Power Charger is not properly connected to the shade.</p>	<p>Step.1 Connect the Power Charger to the shade once again, ensuring that the connections are properly aligned and free from obstructions.</p> <p>Step.2 Recharge the Power Charger(PB-01S) to full capacity and try again.</p> <p>Step.3 Please contact customer service for further help.</p>
<p>Red Light</p> <p>□% ● 50% ●● 75% ●●●</p> <p>☀</p>	<p>Poor connection or low battery capacity in Power Charger (PB-01S).</p>	<p>Step.1 Connect the Power Charger to the shade again.</p> <p>Step.2 Recharge the Power Charger(PB-01S) to full capacity and try again.</p>
	<p>Exposure to high temperatures.</p>	<p>Let the product cool down to a safe temperature for at least 30 minutes before trying again.</p>
	<p>Other</p>	<p>If the red light still illuminates, please contact customer service for further help.</p>



While charging the Power Charger (PB-01S) Wireless (with battery) Charging Wand

LED Status	Potential Cause	Solution
<p>The LED doesn't illuminate.</p> <p>□% ● 50% ●● 75% ●●●</p> <p>○</p>	<p>The Power Charger is not well connected to the 36W Power Adapter or wall outlet</p>	<p>Step.1 Connect the Power Charger (PB-01S) to 36W Power Adapter again, and check the DC plug of 36W Power Adapter is well installed.</p> <p>Step.2 Check the 36W Power Adapter plug is well plugged into wall outlet</p> <p>Step.3 Make sure that there is no obstruction in charging port. If the light still doesn't illuminate, please proceed to check the next potential cause.</p>
<p>Red Light</p> <p>□% ● 50% ●● 75% ●●●</p> <p>☀</p>	<p>Exposure to high temperatures.</p>	<p>Let the product cool down to a safe temperature for at least 30 minutes before trying again.</p>
	<p>Other</p>	<p>Please contact customer service for further help.</p>
<p>Red Light</p> <p>□% ● 50% ●● 75% ●●●</p> <p>☀</p>	<p>Other</p>	<p>Please contact customer service for further help.</p>

Safety Precautions

Thank you for your purchase. Please review the instructions carefully before using the product, and save these instructions for future consultation.

- Important safety instructions. Follow all instructions, since incorrect installation may lead to severe injury.
- The Power Charger(PB-01S) contains Lithium-ion batteries; the battery contains flammable materials such as organic solvents. Please read the Important Safety Precautions before using the product.
- Please refrain from charging in environments above 35°C / 95°F or below 5°C / 41°F.
- These accessories are designed to be used with authorized Motorized Shades. Please do not use them for any other purpose.
- Please store the product in a well ventilated area and away from fire, high temperatures or direct sunlight.
- **DO NOT** shake or drag the Power Charger while charging.
- **DO NOT** operate the shade while charging.
- **DO NOT** touch the contact pads / pins / slots of charging apparatus. Doing so may cause electric shock or damage to the product.
- To avoid water or dust, shield the charging connector with dust cover when not in use.
- **DO NOT** use or leave the product near sources of liquid or heat to avoid electric shock and / or risk of fire.
- Only use the 36W Power Adapter included with this product , the use of unauthorized adapters may cause product damage or raise safety concerns.
- **DO NOT** disassemble the Power Charger, or any of their components. They do not contain serviceable parts. Servicing of these products should be referred to qualified personnel.
- **DO NOT** operate the product with wet hands to avoid risk of electrical shock. The product needs to be powered off and disconnected from its power source during cleaning, maintenance and when replacing parts.
- Please note that the limited warranty will be voided if the product is modified, dismantled or used in any manner other than its intended purpose.
- The product is not to be used by persons such as children, those with reduced physical, sensory or mental capabilities, or those who lack experience and knowledge of the product, unless they have been given supervision or instruction.
- **DO NOT** allow children to play with the products. Keep them away from children.
- Frequently examine the installation for imbalance and signs of wear or damage to cables and springs. Do not use if repair or adjustment is necessary.
- **DO NOT** operate when maintenance, such as window cleaning, is being carried out in the vicinity.

Important Safety Precautions

The Power Charger (PB-01S) contain lithium-ion batteries; the battery contains flammable materials, such as organic solvents. Mishandling of the battery may cause fire, smoke, or explosion.

▲ DANGER:

- Do not immerse the battery in any liquid, such as water, beverages, or other fluids.**
Exposure to liquid may damage the battery or the battery pack. Damaging the battery may generate heat, smoke, catch fire, or explode.
- Do not use or place the battery in or near an open flame, heater or high temperature areas (above 80°C or 176°F) , such as those near a microwave or other cooking appliance.**
Subjecting the battery to high temperature or near electromagnetic radiation may damage the polyolefin separator and can cause short circuit. This may cause the battery to generate heat, smoke, catch fire, or explode.
- About Charging: Do not use unauthorized chargers.**
Only charge the battery within recommended conditions (e.g., temperature range, voltage, and current). Use of an unauthorized charger could cause the battery to generate heat, smoke, catch fire, or explode.
- Do not attach or insert battery with polarity reversed.**
If the battery does not easily fit into the charger or device, check the battery orientation. Do not force the battery into the compartment. If the battery is inserted incorrectly, the battery may generate heat, smoke, catch fire, or explode.
- Do not connect the battery to an AC outlet or DC automotive plug.**
The battery requires a specific charger. If the battery is connected directly to a power outlet, the battery may generate heat, smoke, catch fire, or explode.
- Do not use the battery in equipment for which it was not intended.**
If the battery is used in unapproved applications or systems, the battery may be damaged and generate heat, smoke, catch fire, or explode.
- Keep the battery away from heat and fire.**
Excessive heat will damage the battery and may cause it to generate smoke, catch fire, or explode.
- Do not connect the positive (+) and negative (-) terminals with a conductive material.**
Do not carry or store the battery with any metal objects. If the battery is shorted, it may overheat and the battery may generate heat, smoke, catch fire, or explode.
- Avoid excessive impact to the battery.**
Impact beyond specification may damage the battery. This may cause the battery to leak, generate heat, smoke, catch fire, or explode.
- Do not penetrate the battery with any sharp object.**
If subjected to a hard strike or penetrated by an object, the battery may be damaged, thereby causing the battery to short-circuit. This may cause the battery to generate heat, smoke, catch fire, or explode.
- Do not directly solder to the battery.**
Soldering directly to the battery could melt the separator, damage the fume release vent or other safety mechanisms. This may cause the battery to generate heat, smoke, catch fire, or explode.
- Do not disassemble the battery.**
Disassembly or modification of the battery may damage the protection circuit. This may cause the battery to generate heat, smoke, catch fire, or explode.
- Do not charge the battery near high temperatures.**
If the battery is charged while exposed to high temperatures, the battery's protection circuit may activate and prevent charging, or fail and cause the battery to generate heat, smoke, catch fire, or explode.

Important Safety Precautions

▲ CAUTION:

- Exposure to Direct Sunlight**
Do not use or leave the battery in a location exposed to excessive heat, such as in direct sunlight or in a car. Doing so could cause the battery to generate heat, smoke, catch fire, or explode. It may also cause the battery's performance and life to deteriorate.
- Use with other Equipment or Power**
The battery pack has a protection circuit. Do not use the battery with other equipment or power as it may damage the protection circuit. If the protection circuit fails, the battery may generate heat, catch fire, smoke, or explode.
- Charging Temperature Range**
Only charge the battery between 5°C and 35°C. Charging outside of this temperature range may cause the battery to leak, generate heat, or result in serious damage. It may also cause the battery's performance and life to deteriorate.
- Charging Method**
Read the user's manual for proper product charging method.
- First Time Usage**
Please contact the supplier if the battery gives off an unusual odor, generates heat, or shows signs of rust prior to its initial use.
- Flammable Materials**
Do not charge or discharge near flammable materials. Doing so could result in fire.
- Handling of Exposed Contacts or Conductors**
If the battery pack has a system interface consisting of stripped lead wires or exposed contact plates, handle with due care. Temporarily insulate exposed contacts and conductors with an insulator such as polypropylene tape or polyvinylchloride tape. Failure to do so could result in an electrical shock; a short circuit causing the battery to generate heat, smoke, catch fire, or explode; or the combustion of other materials.
- Recycling**
When disposing of the battery, recycle it according to local rules and regulations.

Important Safety Precautions

▲ WARNING:

- Ingestion**
Keep away from small children.
Keep the battery away from small children. If the battery or any of its component parts is swallowed, seek medical attention immediately.
- Mixed Use**
Do not mix with other batteries.
The battery should not be used with other batteries having a different capacity, chemistry, or manufacturer. Doing so could cause the battery to generate heat, smoke, catch fire, or explode.
- Rust, Discoloration and Deformities**
Do not use abnormal batteries.
Immediately stop using the battery if there are noticeable abnormalities, such as smell, heat, discoloration, or deformity. The battery may be defective and could generate heat, smoke, catch fire, or explode with continued use.
- Charging Time**
Stop charging if the charging process cannot be finished.
If the battery cannot finish the charging process within the specified time, halt the charging process. The battery may generate heat, smoke, catch fire, or explode.
- Leakage -1**
Do not use a leaking battery near open flame.
If the battery or liquid leaking from the battery has an irritating odor, the battery should be kept away from any open flame. If exposed to an open flame, the battery could ignite and explode.
- Leakage -2**
Do not touch a leaking battery.
If liquid leaking from the battery gets into your eyes or makes contact with your skin, immediately flush your eyes or skin with clean water and seek medical attention. If left untreated, it will cause significant eye or skin damage.
- Transport**
Pack the battery securely for transport.
To prevent short-circuit or damage during transport, securely pack the battery in a case or carton.